

# VIETNAM'S LEADING FOR-RENT INDUSTRIAL DEVELOPER

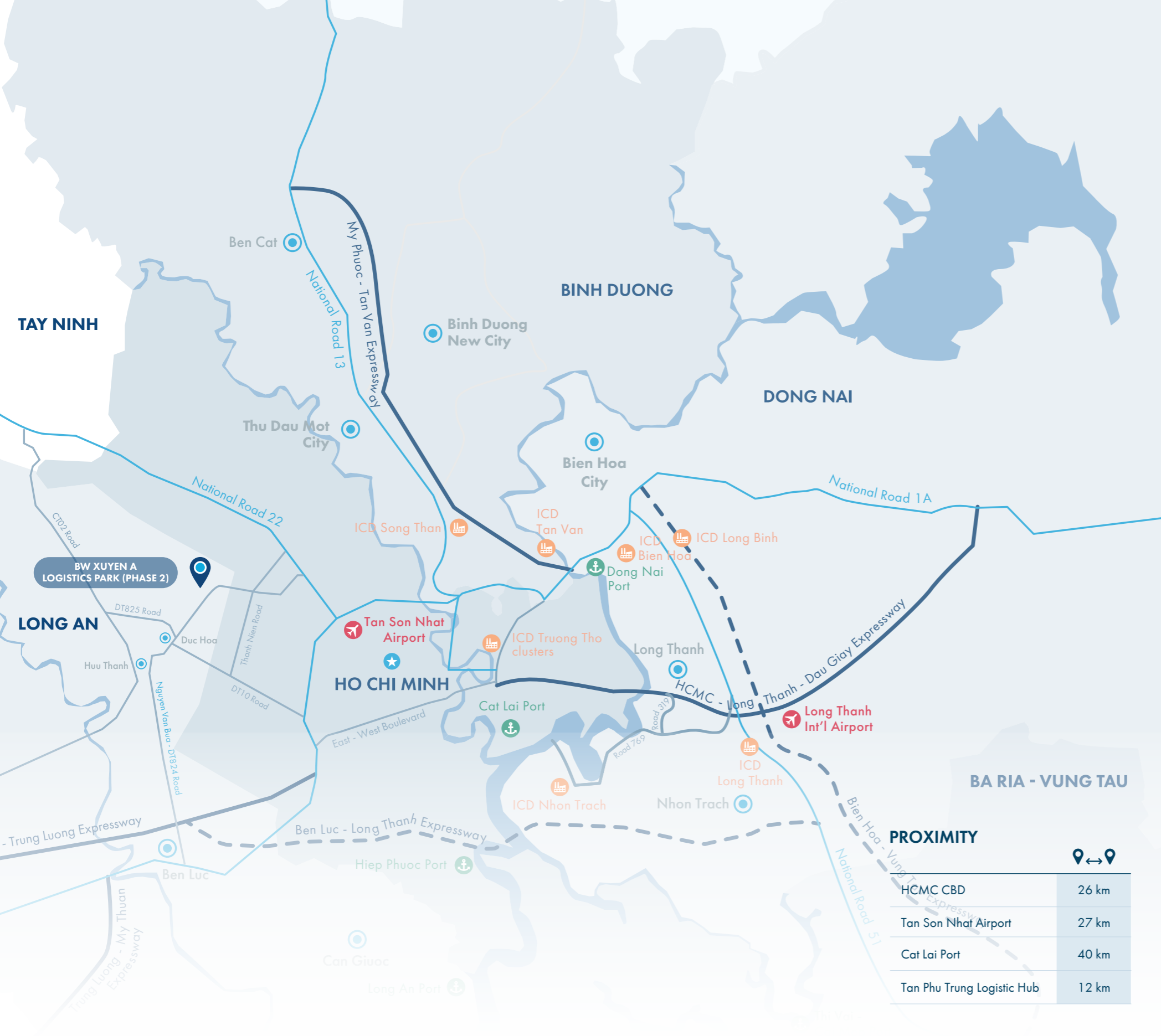

**BW XUYEN A  
LOGISTICS PARK (PHASE 2)**

**PROXIMITY**

	↔
HCMC CBD	26 km
Tan Son Nhat Airport	27 km
Cat Lai Port	40 km
Tan Phu Trung Logistic Hub	12 km



**READY-BUILT WAREHOUSE  
BW XUYEN A LOGISTICS PARK  
(PHASE 2)  
LONG AN**

## LAND LOT

Lot LK  
Street 1 Xuyen A IP, My Hanh Bac Commune,  
Duc Hoa District, Long An Province



## SPECIFICATION

### BUILDING

<b>Clear Height</b>	GF: 9m 2F: 9m Office: 2.8m
<b>Platform Height</b>	1.3m
<b>Floor Loading</b>	GF: 3 tons/sqm 2F: 2.5 tons/sqm
<b>Column Width * Span</b>	GF: 11.5 x 11.9m 2F: 11.5 x 23.8 - 12.15m
<b>Loading dock</b>	2-5 docks 2-5 reserved docks per unit
<b>Loading bay</b>	Dock leveler 6m canopy

### FACILITIES

<b>Sectional Door</b>	3.5m height
<b>Lighting</b>	150 lx (warehouse area) 300 lx (office area)
<b>Fire Fighting System</b>	ESFR system
<b>Power Supply</b>	20 VA/sqm



Hotline: (+84) 28 710 29 000  
Email: leasing@bwidjsc.com  
Website: <https://bwindustrial.com>

The listed dimension is in form of Gross Leasable Area (GLA).

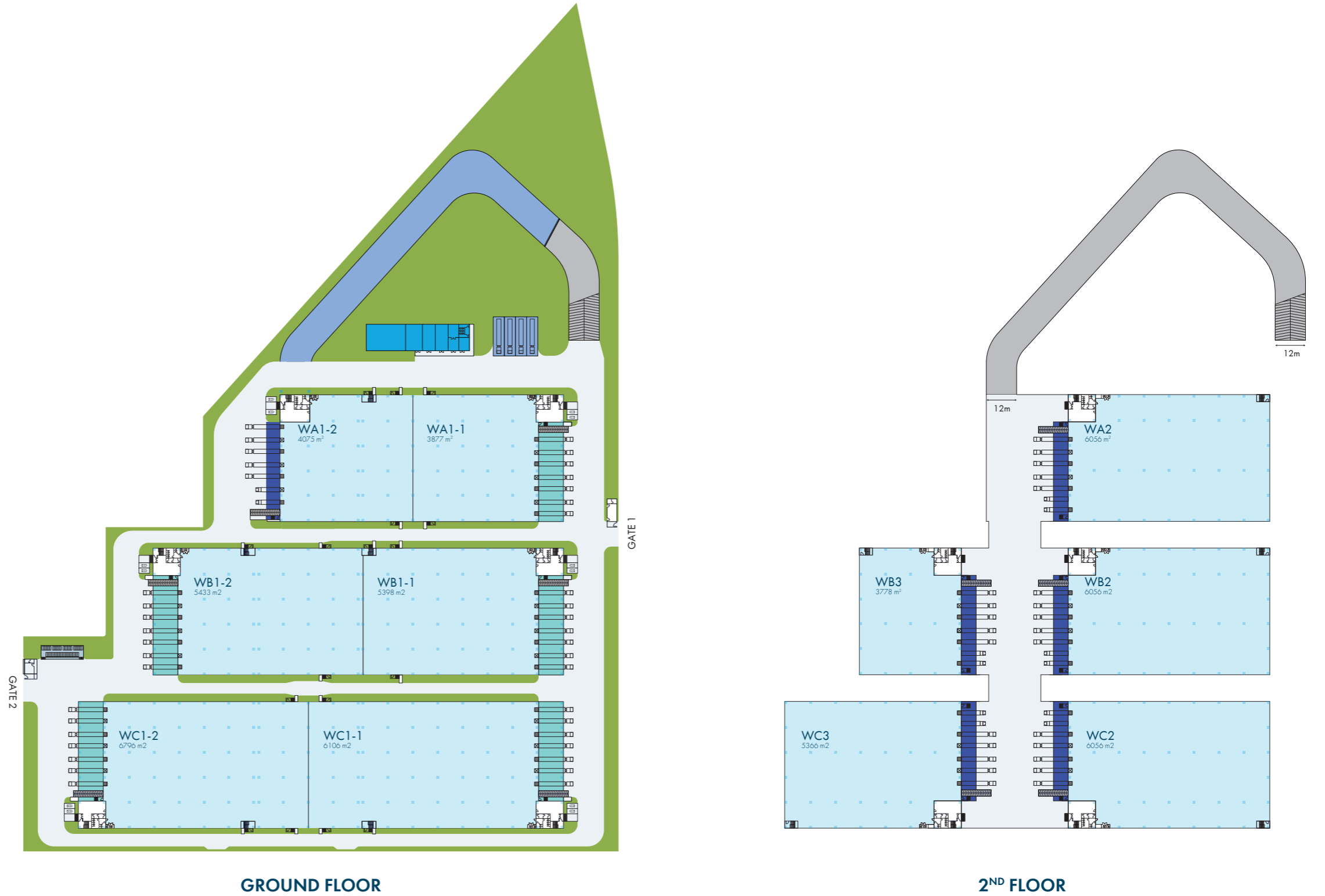
While every care has been taken to ensure the accuracy of the plans at the time of printing, the Developer will not be held responsible for any changes due to authority requirement.



## LEGEND

 Ramp	 Warehouse	 Office	 Parking area
 Loading area	 Utility house	 Canopy	 Green area